



SL Sanitary Cartridge Filter Housing Instruction Manual



Contents

Notice	2 - 3
Know Your Product	4
Instruction Manual.	5 - 6

Notice

1. Please install and test the housing according to the product instruction manual.
2. This product is designed for filter equipment used for water filtration only; please don't use it on other purpose to avoid danger.
3. This product is categorized as pressure vessel, only professional or well-trained person who can install and operate it.
4. Please read through the instruction manual before moving, installing and using this product.
5. Please check the product and make sure that there is no any damage or components lost before installing it. If the product was damaged, deformed or leaking, please stop using the housing.
6. Please make sure that if the fluid is suitable for the filter before using.
7. Please use the product according to the instruction manual and make sure that the design pressure and the operating pressure are in the required range.
8. The filter housing must be installed and fixed on the level ground. Please do not fix it on the uneven ground.
9. Please do not open the top cover randomly before piping.
10. Installing the pressure control valve is suggested to keep the water pressure from the suddenly increased/decreased water pressure happens.

11. Please avoid rapid switching of the ball valve and continuous countercurrent which may cause damage to filter and housing while using the product.
12. Be sure to relieve the pressure inside the filter housing completely before replacing filter cartridges.

Please be cautious with the possibility of fluid ejection when it is at a high temperature.
13. Please use the suitable O-ring and check it regularly then replace it if necessary. Deterioration or damage of the O-ring may cause fluid leakage.
14. The internal plastics components will deteriorate by long-term use. Please check it regularly and replace it if deterioration or damage is found.

Know Your Product

No.	Description	No.	Description	No.	Description
1	Clamp	2	Vent	3	Top Cover
4	O-Ring	5	Center Post	6	Nut
7	Pressure Plate	8	Shell Flange	9	Shell
10	Handle	11	Base	12	Inlet
13	Outlet	14	Support Leg		

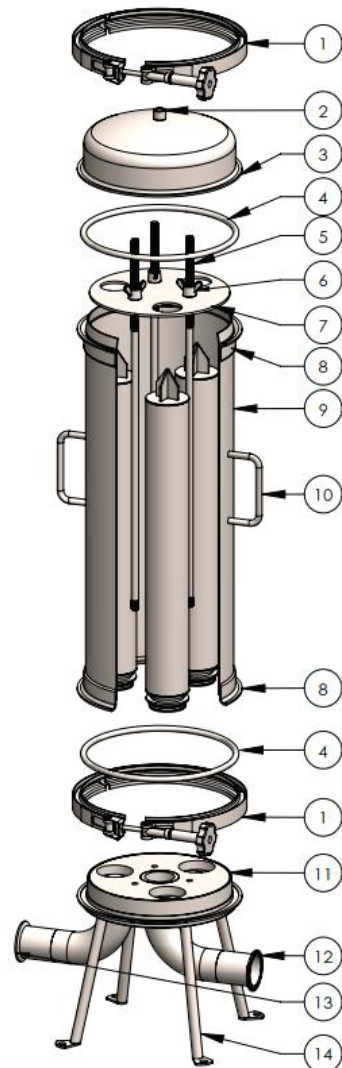
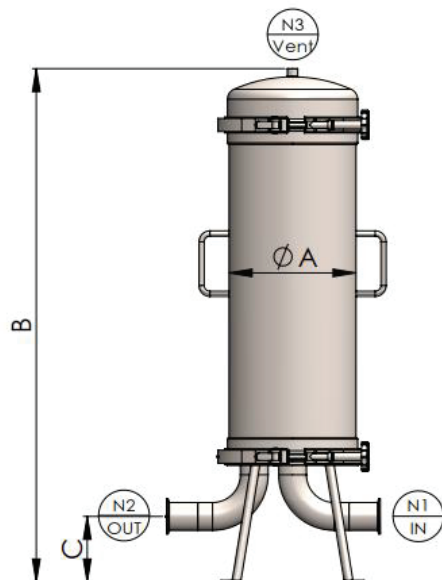
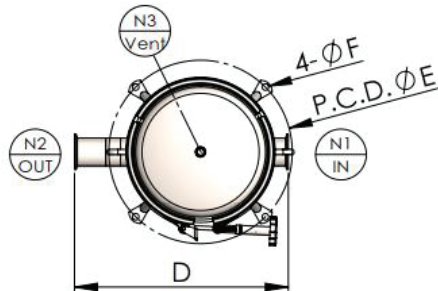

Instruction Manual

1. Fix :

- a. Adjust 14 Support leg and put the filter housing into the proper position, then fix it on the ground or board.

2. Pipe :

- a. Connect the ⑫Inlet and ⑬Outlet to the main pipe.
- b. Install the exhaust valve and pressure gauge at the ②Vent

3. Open the filter and install the internal parts :

- a. Unfasten the top and bottom ①Clamp. Lift up and remove the ③Top Cover and ⑨Shell. Fasten the ⑤Center post and aim to the center with cartridge and insert it. Put ⑦Pressure plate and fasten the ⑥Nut. The installation of the internal cartridge is done.
- b. Check the ④O-ring, be sure it is in the groove.
- c. Put ③Top Cover and ⑨Shell from the top down in parallel and place on the ④O-ring. Open the ①Clamp, align it to the connection of the ⑪Base and ⑤Shell flange, and fasten and lock the ①Clamp tightly.

4. Testing :

- a. Open the ②Vent and pour the water in until water comes from ②Vent.
- b. Close the exhaust valve at ②Vent.

- c. Keep the above step for 30 minutes and checks whether there is leaking.

5. Stop leak ing :

- a. If the leakage was found, please close ⑫Inlet and loosen ②Vent to relieve the inner pressure.
- b. Unfasten ①Clamp and fasten it again.
- c. Open ⑫Inlet, increase pressure slowly and check if there is any leakage.
- d. If not, please open ⑫Inlet and ⑬Outlet to start working.

6. Stop running :

- a. Please close ⑫Inlet and ⑬Outlet first.
- b. Stop running water and open ②Vent.
- c. Please open the filter housing after relieving the inner pressure.